



Ohio Avenue Bridge Replacement & Detour Information

About the Project

The Ohio Avenue Bridge (First Bridge), which spans the Penrose Canal, will be replaced in its entirety. Ohio Avenue will be closed for the duration of the construction from East Riverside Drive to Horace Bryant Jr. Drive. The project is anticipated to begin construction the week of December 6, 2021 and last approximately six (6) months.

Detour (see attached traffic control plans)

- Generally, the detour route traveling east on Ohio Avenue will direct motorists to the eastbound service road on Eastbound Route 30 and to Huron Avenue.
- Traveling west on Ohio Avenue, the detour route will generally direct motorists to MLK/Route 30 Intersection to Route 30 to the westbound service road adjacent to Route 30 westbound and Gramercy Avenue.

REMINGTON & VERNICK ENGINEERS
 232 KINGS HIGHWAY EAST
 HADDONFIELD, NJ 08033
 (856) 795-9595, FAX (856) 795-1882
 WEB SITE ADDRESS: WWW.RVE.COM
 Certification of Authorization: 24 GA 28003300
 --ENGINEERING EXCELLENCE--

DATE: 12-18-2020
FRANK J. SENEY JR.
 NJ PROFESSIONAL ENGINEER LIC. NO. 35321

PLANS WHICH DO NOT BEAR AN EMBOSSED SEAL ARE NOT VALID.

ALL DOCUMENTS PREPARED BY REMINGTON & VERNICK ENGINEERS AND AFFILIATES ARE INSTRUMENTS OF SERVICE IN RESPECT OF THE PROJECT. THEY ARE NOT INTENDED OR REPRESENTED TO BE SUITABLE FOR REUSE BY OWNER OR OTHERS ON EXTENSIONS OF THE PROJECT OR ON ANY OTHER PROJECT. ANY REUSE WITHOUT WRITTEN VERIFICATION OR ADAPTATION BY REMINGTON & VERNICK ENGINEERS AND AFFILIATES FOR THE SPECIFIC PURPOSE INTENDED WILL BE AT OWNERS SOLE RISK AND WITHOUT LIABILITY OR LEGAL EXPOSURE TO REMINGTON & VERNICK ENGINEERS AND AFFILIATES. AND OWNER SHALL INDEMNIFY AND HOLD HARMLESS REMINGTON & VERNICK ENGINEERS AND AFFILIATES FROM ALL CLAIMS, DAMAGES, LOSSES AND EXPENSES ARISING OUT OF OR RESULTING THEREFROM.

NO.	REVISION	DATE	BY

TRAFFIC DETOUR PLAN
 ATLANTIC CITY
 REPLACEMENT OF OHIO AVENUE BRIDGE
 ATLANTIC COUNTY
 ATLANTIC CITY
 NEW JERSEY

DRAWN BY:	DESIGN BY:	CHECKED BY:	SCALE:
JAR	JAR	FJS	AS NOTED
DATE:	10/9/2019	SHEET NO.:	11 of 21
JOB NO.:	0102U006		

CONSTRUCTION SIGN TABLE

LEGEND	SIGN	TYPE		LEGEND	SIGN	TYPE	
		COLOR	SIZE			COLOR	SIZE
A	ROAD CLOSED	R11-2 BLACK ON WHITE	48"x30"	H	← DETOUR	M4-10L BLACK ON ORANGE	48"x18"
B	OHIO AVENUE 6"B	BLACK ON ORANGE	30"x12"	I	ROAD CLOSED 500 FT	W20-3 BLACK ON ORANGE	36"x36"
AC-1	THIS BRIDGE WILL BE CLOSED ON OR ABOUT DATE PLATE PLAN ALTERNATE ROUTE	4"C 4"C	SPECIAL 60"x36"	J	ROAD CLOSED 1000 FT	W20-3 BLACK ON ORANGE	36"x36"
		4"C		K	ROAD CLOSED 1500 FT	W20-3 BLACK ON ORANGE	36"x36"
C	BRIDGE OUT OHIO AVENUE LOCAL TRAFFIC ONLY	R11-3b(MOD) BLACK ON WHITE	72"x30"	L	↗ DETOUR	M4-9 (MOD1) BLACK ON ORANGE	30"x24"
D	END DETOUR	M4-8a BLACK ON ORANGE	24"x18"	M	↶ DETOUR	M4-9 (MOD2) BLACK ON ORANGE	30"x24"
		M4-9L BLACK ON ORANGE	30"x24"	N	↵ DETOUR	M4-9 (MOD3) BLACK ON ORANGE	30"x24"
E	← DETOUR	M4-9R BLACK ON ORANGE	30"x24"	O	→ DETOUR	M4-10L BLACK ON ORANGE	48"x18"
F	→ DETOUR	M4-9X BLACK ON ORANGE	30"x24"	P	EMS ONLY LANE	BLACK ON WHITE	48"x30"
G	↑ DETOUR				KEEP RIGHT	R4-7A BLACK ON WHITE	48"x36"
Q							

* SERIES 2000 STANDARD ALPHABET LETTER TYPE AND HEIGHT (TYP.)

TRAFFIC CONTROL & DETOUR NOTES

- TRAFFIC CONTROL SHALL BE IN ACCORDANCE WITH THE "NEW JERSEY DEPARTMENT OF TRANSPORTATION (NJDOT) STANDARD SPECIFICATIONS FOR ROAD AND BRIDGE CONSTRUCTION 2019," SECTION 159 - "TRAFFIC CONTROL" AND NJDOT TRAFFIC CONTROL DETAILS, 2016.
- ALL TRAFFIC CONTROL DEVICES AND MARKINGS SHALL CONFORM TO THE STANDARDS OF THE CURRENT "MANUAL ON UNIFORM TRAFFIC CONTROL DEVICES FOR STREETS AND HIGHWAYS" AND "STANDARD HIGHWAY SIGNS" PUBLICATIONS FROM THE FEDERAL HIGHWAY ADMINISTRATION.
- ANY TRAFFIC CONTROL DEVICES LOST, STOLEN OR DAMAGED SHALL BE REPLACED IMMEDIATELY.
- ALL CONSTRUCTION BARRIER CURB SHALL BE TYPE 1 OR TYPE 4, JOINT CLASS "A".
- ALL SIGNS AND WARNING DEVICES SHALL BE APPROVED BY THE CITY ENGINEER OR REPRESENTATIVE.
- THE CONTRACTOR SHALL NOTIFY THE CITY ENGINEERS OFFICE AT LEAST 48 HOURS PRIOR TO THE INSTALLATION OF DETOUR SIGNS.
- THE CONTRACTOR SHALL NOTIFY THE ATLANTIC CITY POLICE, RESCUE, FIRE DEPARTMENT AND SCHOOL DISTRICT ONE WEEK PRIOR TO THE START OF CONSTRUCTION AND AT LEAST 48 HOURS PRIOR TO IMPLEMENTATION.
- ALL SIGNS SHALL BE LOCATED WITHIN THE STATE, MUNICIPAL OR COUNTY RIGHT OF WAY.
- INSTALL ORANGE PLASTIC RETROREFLECTIVE CAUTION FENCE AT EACH CORNER OF THE BRIDGE AS SHOWN FOR PEDESTRIAN PROTECTION.
- ALL SIGNS AND BARRICADES SHALL BE FURNISHED, PLACED AND MAINTAINED BY THE CONTRACTOR.
- DATE PLATE SHALL BE 30" x 12" WITH 4" C LETTERS.
- ALL EXISTING ROAD SIGNS, PAVEMENT MARKINGS AND/OR PLOWABLE PAVEMENT REFLECTORS WHICH CONFLICT WITH THE PROPOSED TRAFFIC CONTROL PLAN SHALL BE COVERED, REMOVED OR RELOCATED AS DIRECTED BY THE ENGINEER.
- MAINTENANCE AND PROTECTION OF TRAFFIC SHALL BE IN ACCORDANCE WITH "THE MANUAL OF UNIFORM TRAFFIC CONTROL DEVICES" (MUTCD 2009) - PART 6 "TEMPORARY TRAFFIC CONTROL," UNLESS OTHERWISE NOTED IN THE PLANS AND SPECIFICATIONS.
- THE PLACEMENT AND OR RELOCATION OF PRECAST CONCRETE CURB, CONSTRUCTION BARRIER SHALL BE DONE AT THE END OF EACH WORK DAY. THE BARRIER CURB SHALL BE PLACED ACROSS OHIO AVE BRIDGE TO PREVENT VEHICLES FROM ENTERING THE WORK SITE AS SHOWN ON THE PLAN.
- THE CONTRACTOR SHALL OBTAIN AND PAY FOR A NJDOT HIGHWAY OCCUPANCY PERMIT (HOP) FOR DETOUR SIGNS PLACED IN THE ROW OF ROUTE 30.
- TEMPORARY TRAFFIC STRIPES AND SYMBOLS, LATEX SHALL BE MAINTAINED IN PROPER VISUAL CONDITION AS DETERMINED BY THE OWNER. SEPARATE PAYMENT WILL NOT BE MADE FOR RE-APPLICATION OF STRIPES AND SYMBOLS BUT THE COST SHALL BE INCLUDED IN THE PRICE BID FOR "TRAFFIC STRIPES AND SYMBOLS, LATEX".
- TEMPORARY PAVEMENT STRIPES AND MARKINGS SHALL BE REMOVED BY MEANS APPROVED BY THE OWNER UPON REMOVAL OF THE DETOUR. SEPARATE PAYMENT WILL NOT BE MADE BUT THE COST SHALL BE INCLUDED IN THE PRICE BID FOR "TRAFFIC STRIPES AND SYMBOLS, LATEX".

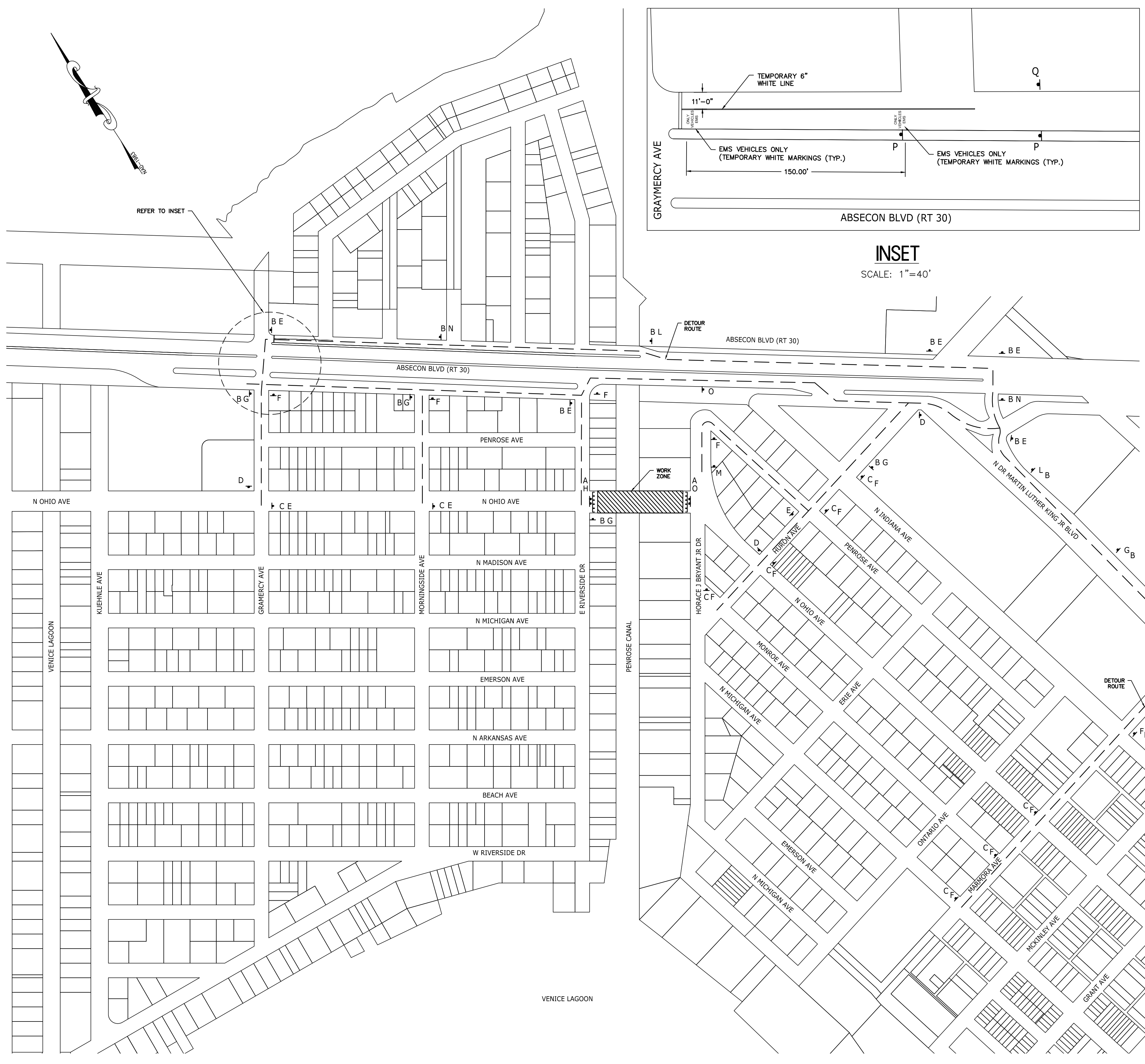

DETOUR ROUTE AND SIGN LOCATIONS

SCALE: 1"=200'
 LENGTH OF DETOUR: 2.1 MILES

DETOUR ROUTE LEGEND

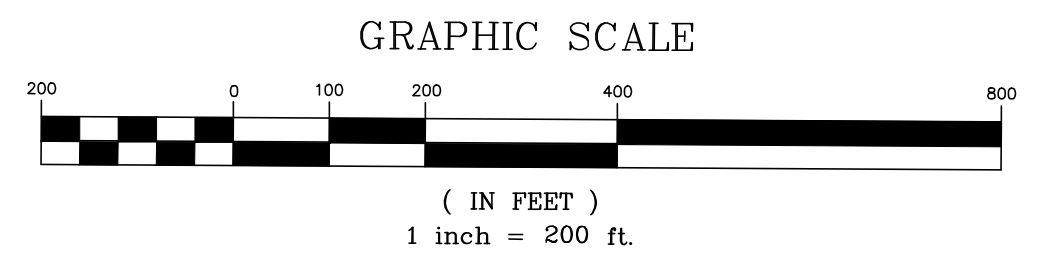
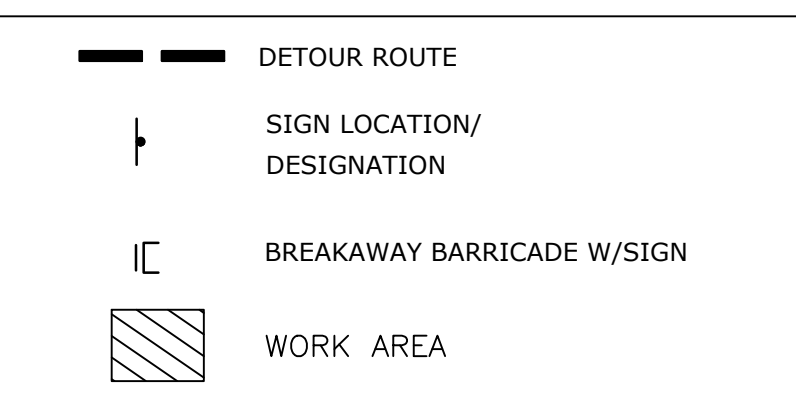

TO BE CONSTRUCTED				
NO.	DESCRIPTION	UNIT	PLAN QUANTITY	AS-BUILT QUANTITY
9	CONSTRUCTION SIGNS	SF	426	
34	TRAFFIC STRIPES, LATEX 6"	LF	200	
35	TRAFFIC MARKING SYMBOLS, LATEX	SF	200	

TC2